

# XPression

## Getting Started

⚠ CAUTION: Before you set up and operate this product, see the “Important Safety Instructions” in your Manual.

When contacting technical support: please provide the information listed on the following label, which is located on the top right front side of the chassis.

Ross Video Ltd.  
Part #: #####  
Issue: #  
Serial #: #####  
###

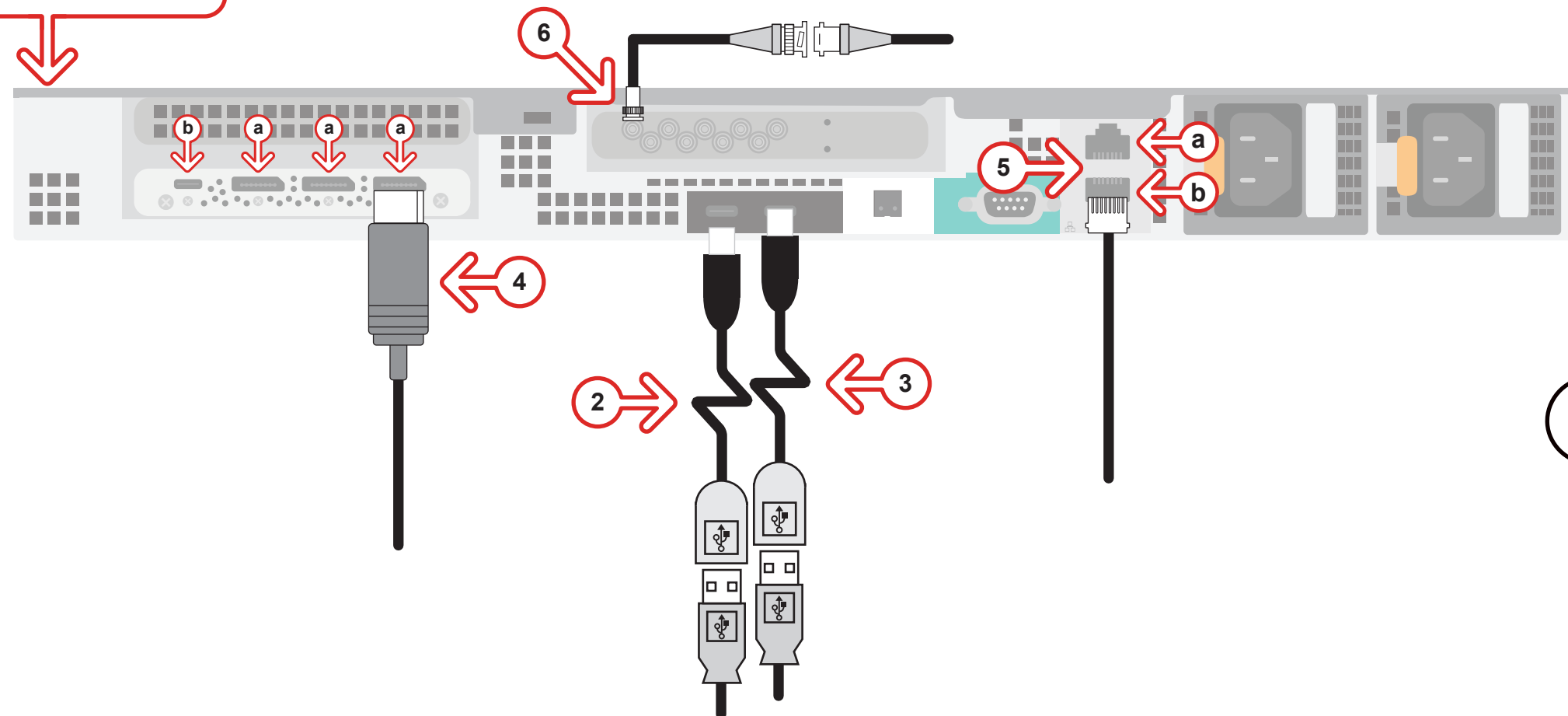

**Need Help?**  
Technical Support:  
1-844-652-0645 (North America)  
+800 1005 0100 (International)  
Email: techsupport@rossvideo.com

- 1 Use the supplied Rack Mount Kit to mount the XPression system in a 19" EIA equipment rack.  
*For information on installing the XPression chassis in a rack, see the provided document “Installing the Chassis in a Rack”.*
- 2 Plug the supplied Keyboard into one of the **USB-C** ports using the supplied USB-C to USB-A adapter.
- 3 Plug the supplied Mouse into one of the **USB** ports using the supplied USB-C to USB-A adapter.
- 4 Connect a Monitor (customer supplied) to any of the three display ports (**a**).  
*A monitor may also be connected to the USB-C port (**b**). When using display ports, ensure the correct display port to DVI adapters are used (DVI-D or DVI-I).*  
*KVM extenders (customer supplied) are required when the XPression system monitor, keyboard, and mouse are located remotely from the rack room.*
- 5 Plug an Ethernet cable from your Local Area Network into either the **1G (a)** or **10G (b) Ethernet** port.  
*XPression systems can be connected to the Internet or restricted production network. The network connection is also used to distribute assets and for the RossTalk/Smart GPI feature.*
- 6 Connect your house reference Genlock signal to the **REF** mini-BNC connector.  
*XPression systems accept analog blackburst or tri-level sync as reference inputs. Tri-level sync is recommended for HD installations.*

*Continued on other side...*

# XPression

## Getting Started continued

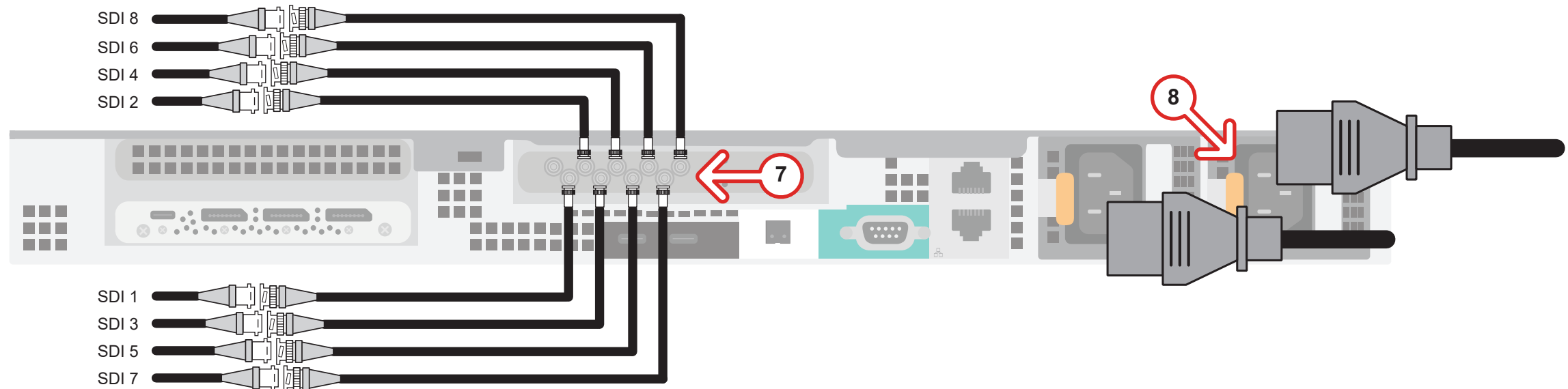

**7** Connect the HD-BNC end of the pigtail cables to the HD-BNC connectors and attach the SDI cables to the BNC end of the pigtails according to their required destination (see the *XPression User Guide* or Help file for information about configuring the key and fill for the HD-BNC connectors). The default configuration is displayed in the table below.

*Not all HD-BNC connectors will be active depending on the XPression software edition. Keep any unused pigtail and SDI cables in a safe place for future use.*

*If your facility requires analog outputs, additional outboard digital to analog conversion equipment is available from Ross Video.*

*Inputs/outputs can be configured in the Hardware Setup in the XPression User Guide or Help file.*

**8** Connect power cords from the AC Ports on the XPression system to the mains power.

*XPression system power supplies are auto-sensing and can use either 110 VAC or 220 VAC.*

**9** On the front of the chassis, press the button on the outer-left side of the door and pull the door outward to remove it from the XPression system.

**10** Press the **Power** button (⏻) on the front of the XPression system.

Wait for the system to finish booting up.

*When shutting down, Ross Video recommends shutting down XPression systems from the Windows operating system.*

**11** Click the XPression user account icon to log onto the system.

**12** Launch XPression from the **Start** menu.

| HD-BNC | Default (2 in 6 out) |
|--------|----------------------|
| 1      | In 1                 |
| 2      | Out 1 Fill           |
| 3      | Out 2 Fill           |
| 4      | Out 3 Fill           |
| 5      | In 2                 |
| 6      | Out 1 Key            |
| 7      | Out 2 Key            |
| 8      | Out 3 Key            |

### For information on...

- operating XPression, see the “XPression User Guide” available in the C:\Archive folder
- other XPression features and functions, see the documents available in the C:\Archive folder