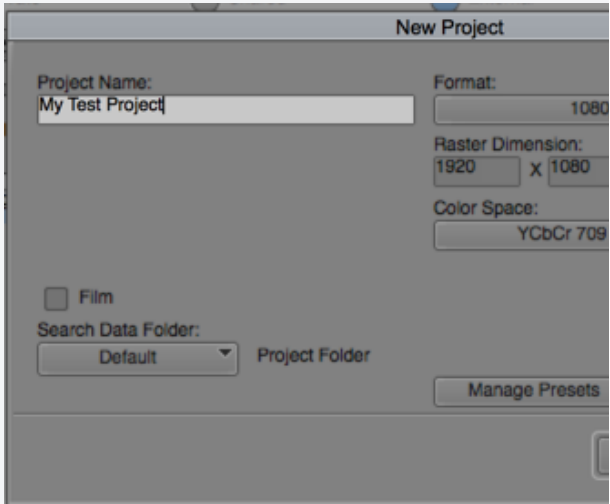
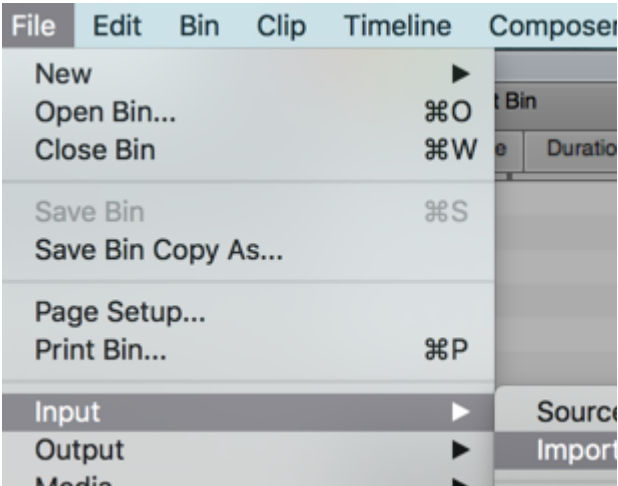
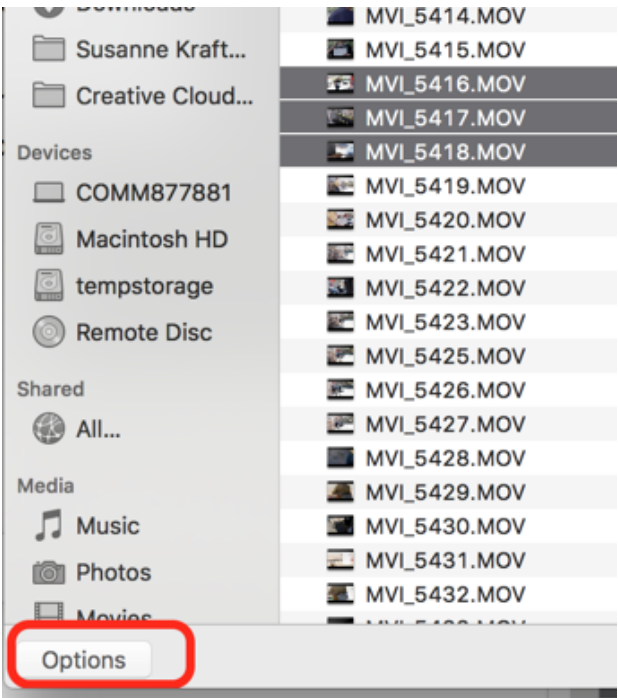

AVID - Importing or Batch Importing footage into AVID

Open AVID and make a project -	
Select a Bin and import the media	
Navigate to the files you would like to import	
Click on Options	

Choose the Resolution = DNxHD 175

Storage drive = your drive or server or tempstorage (this is the local hard drive of the

computer you are working on in the lab)

Next Choose Options so you can tell AVID how to correctly deal with the Aspect Ratio

of the Still Image.

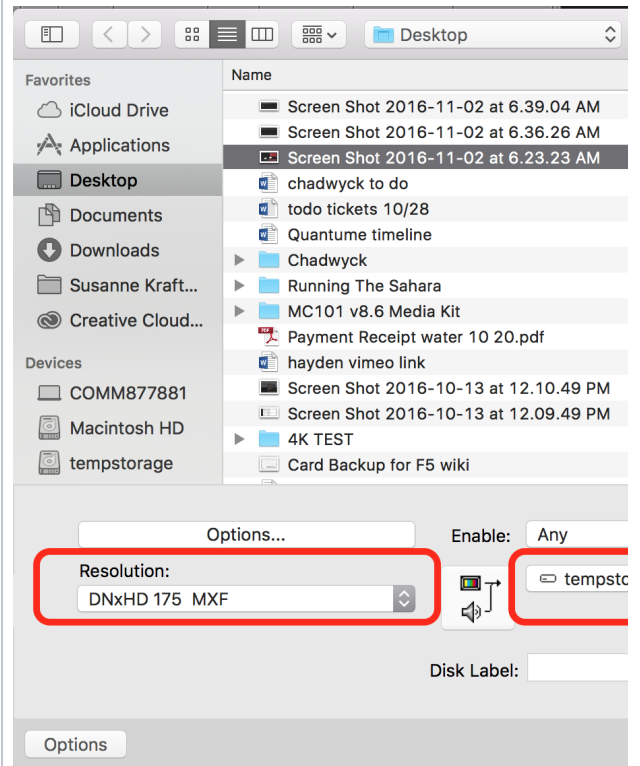
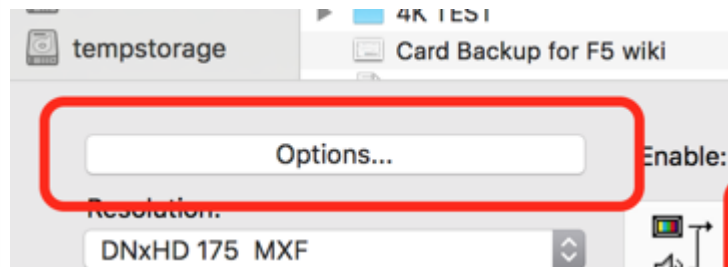

Choose the following settings

- Resize image to fit format raster
 - Color Levels Do Not Modify
 - Frame Import Duration set to 60 seconds
 - Ignore Alpha Channel
 - Uncheck "Autodetect Sequentially-Numbered Files"
- Then click OK on import settings menu to apply the settings

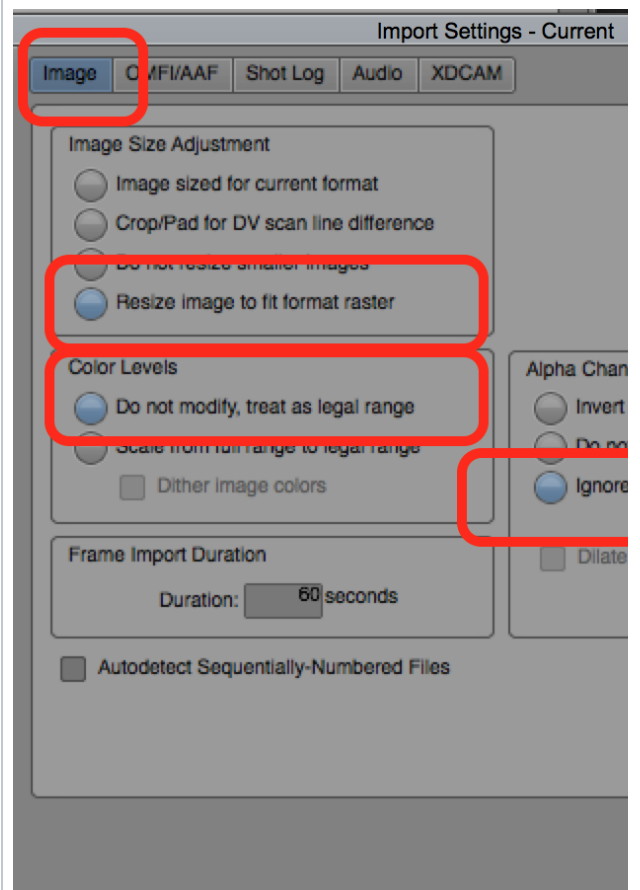

You will return to this menu and select the files or file you want to import and click Open

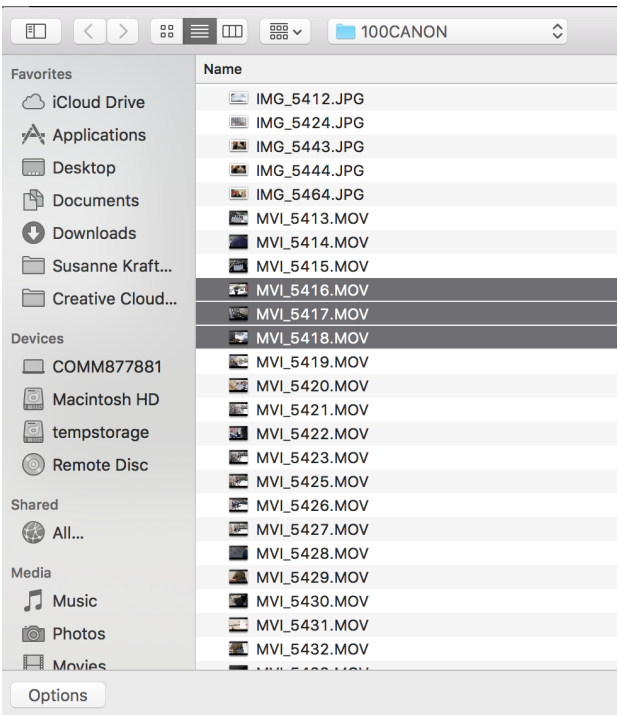

The Files will turn into Master Clips in your bin.
Edit with them as you would any other Master Clip in AVID

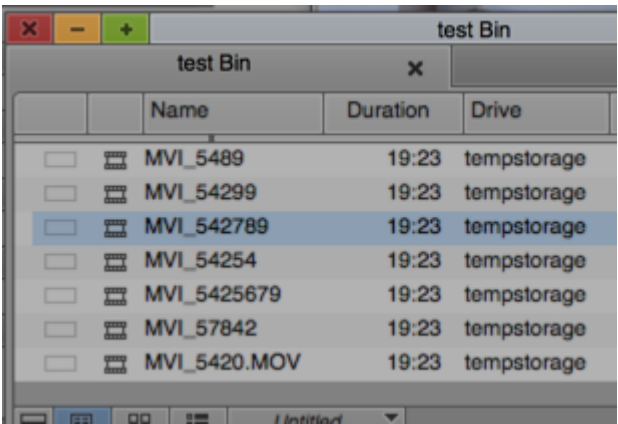

To Batch import Clips back into AVID if your timeline went offline
Select the sequence

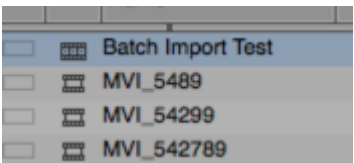

Clip > Batch Re-import

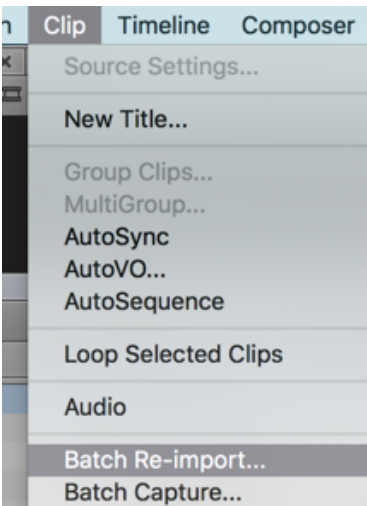

You can choose to use source compression to bring the files in "Natively" or less compressed. But this may not work for all footage. If it doesn't work you must set the "Current" Settings" by selecting that button.

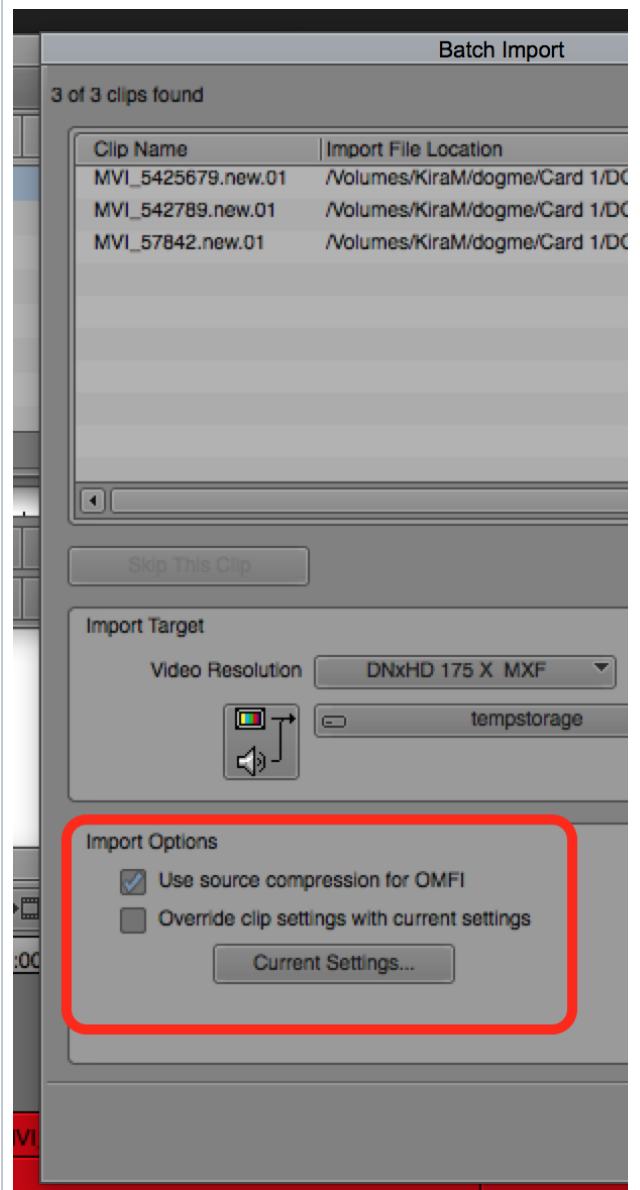

Choose the following settings

- Resize image to fit format raster
 - Color Levels Do Not Modify
 - Frame Import Duration set to 60 seconds
 - Ignore Alpha Channel
 - Uncheck "Autodetect Sequentially-Numbered Files"
-
- Then click OK on import settings menu to apply the settings

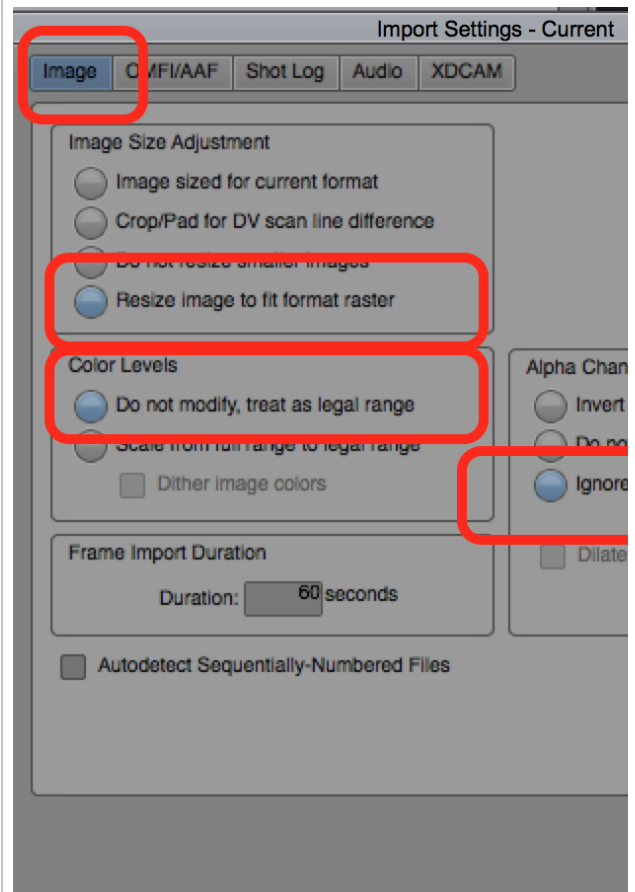

Make sure the box Use Source Compression of OMFI is not checked and choose the Resolution DNxHD 175 X MXF is set

Click Import

