

# AVID to Davinci Resolve - Relinking Red .R3d files for export to Davinci Resolve and Resolve Project Setup

AVID new relinking RED AMA workflow

- 1. Duplicate the sequence and put in a new bin.
- 2. Export a DnxHD Quicktime for "Resolve" as reference. See this wikidoc

<https://wikis.utexas.edu/download/attachments/32934966/AVID-+Export+a+AVID+DNxHD+Quicktime.pdf?version=1&modificationDate=1330040316000>

- 1. Close project and hide the AVID media files so that AVID doesn't relink to the old transcoded media. Change the name to the AVID MediaFiles folder.

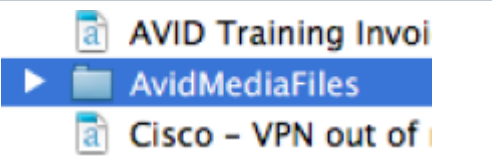
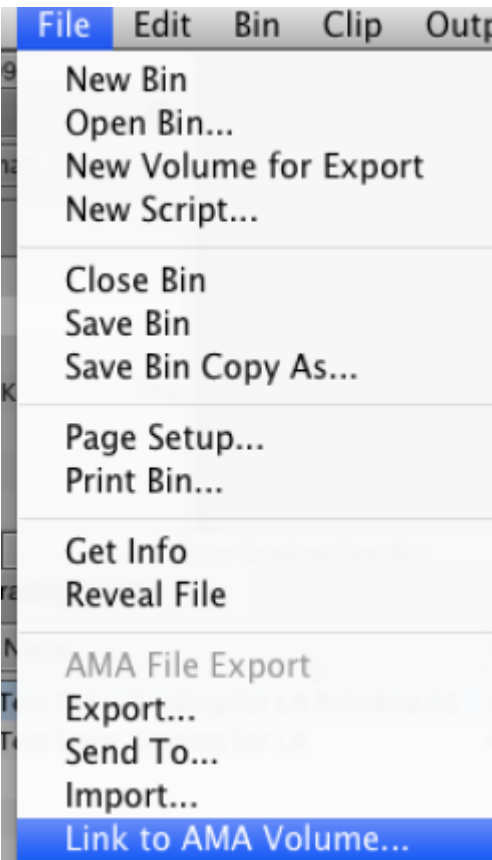
Change from this	
To This	
Relink to the AMA volume that the raw .r3d files are on. Go to >File>Link to AMA Volume	

Click Open

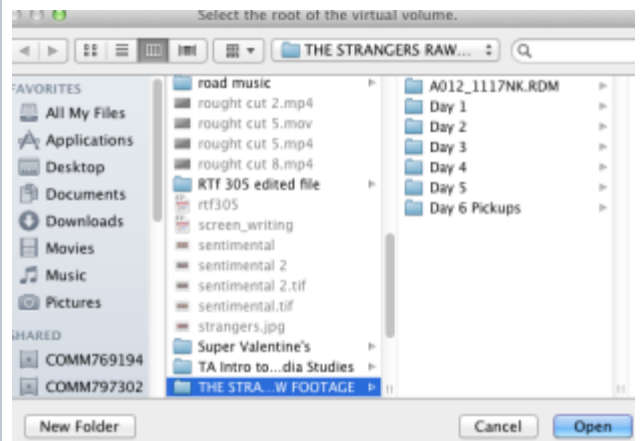

Click OK

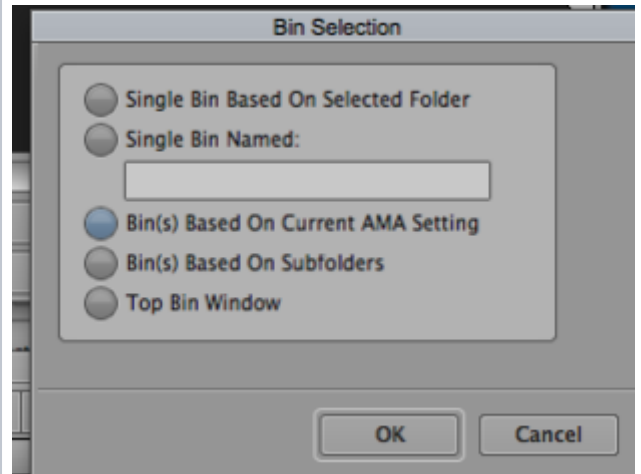

When ready to online reconnect to the .r3d files.

Select all AMA FILES in the  
AMA folder

Right click the sequence to relink and choose Relink

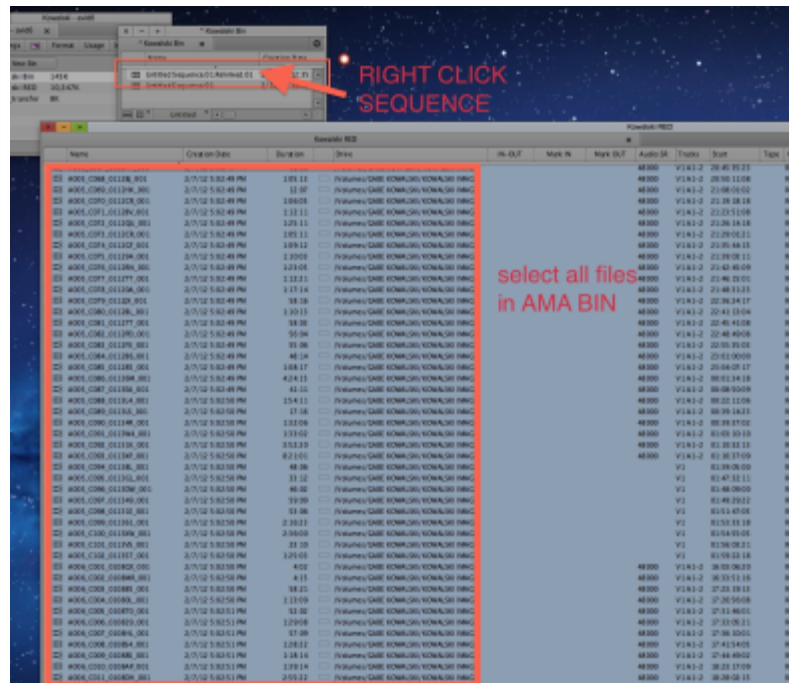

Right click the sequence to relink and choose Relink

>Managed Media

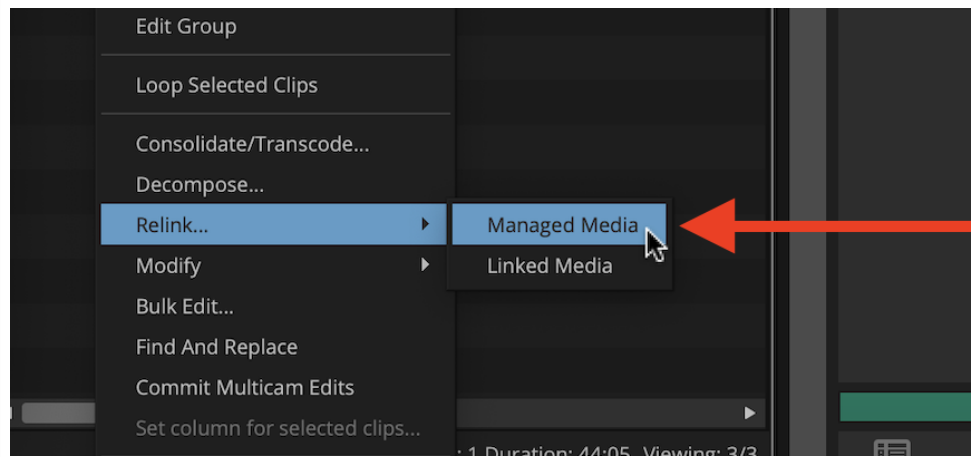

Use the standard relinking options after the AMA media has been mounted

Choose Selected Items in All open bins

Choose to relink by Tape Name or Source file Name

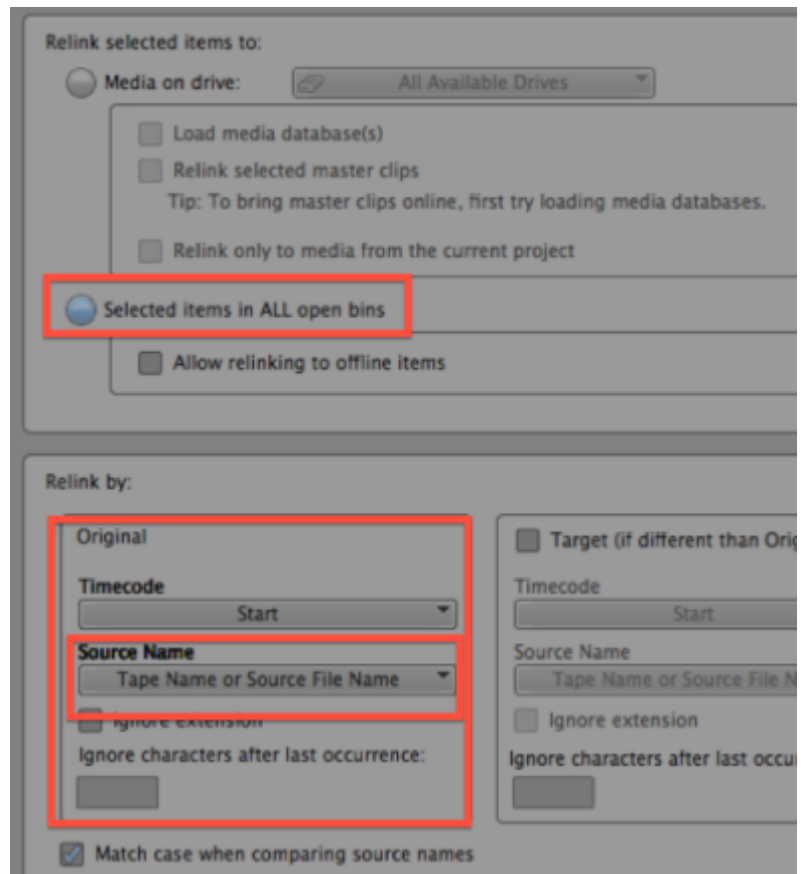

If that doesn't work choose

Choose to relink by Tape Name  
or Source file ID

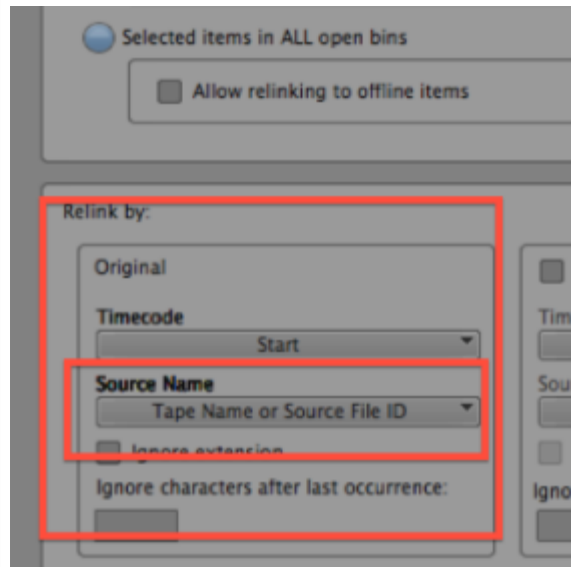

Once the media in the timeline  
is relinked to the .r3d files the  
timeline should look yellow  
showing that the files are  
relinked to AMA media.  
The next step is to export the .  
aaf Go to >File > Export

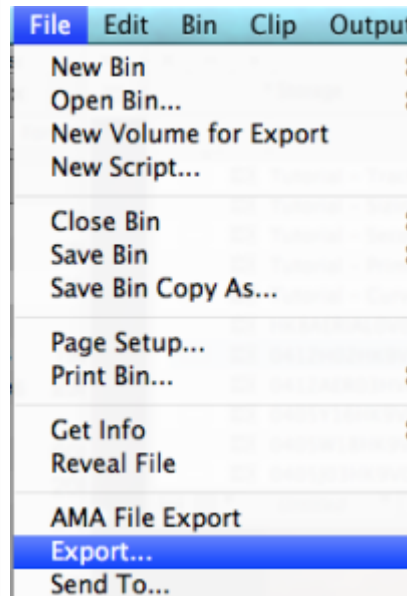

To create the .AAF file

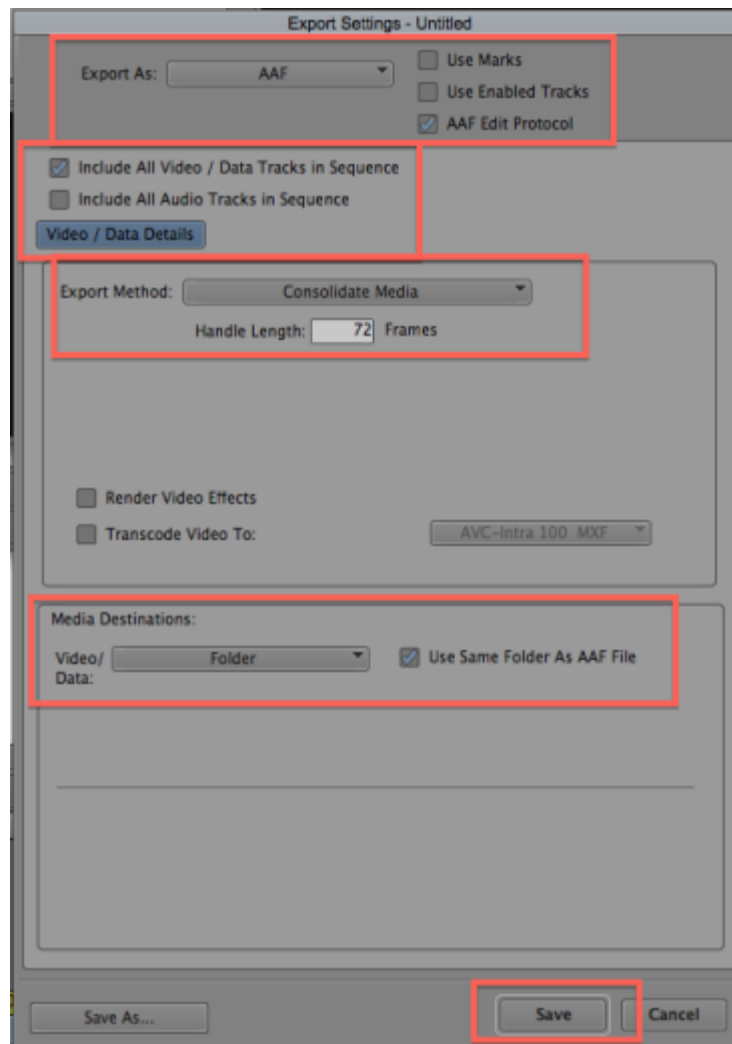

The deliverable will be the .R3D files and the .aaf for the color correction. Example shown here.

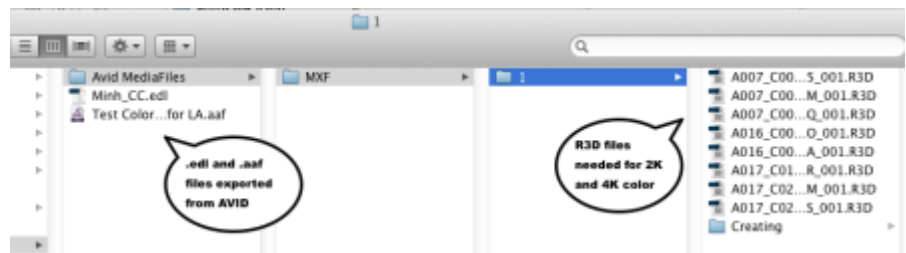

To Bring into Resolve

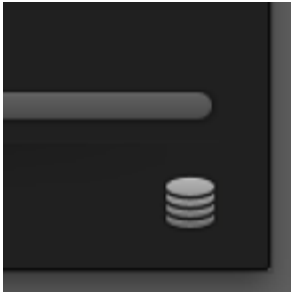
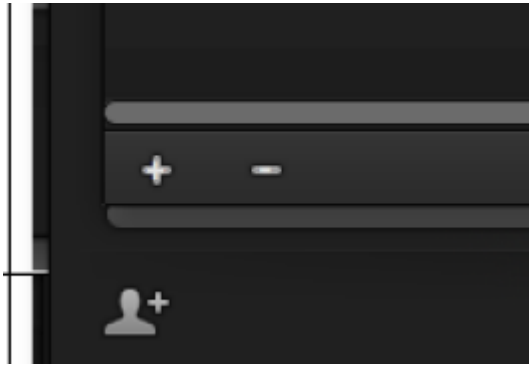
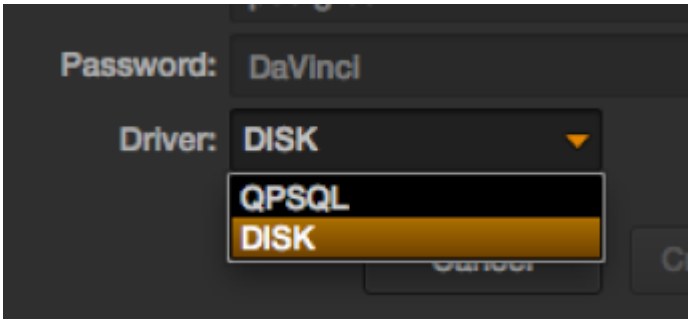
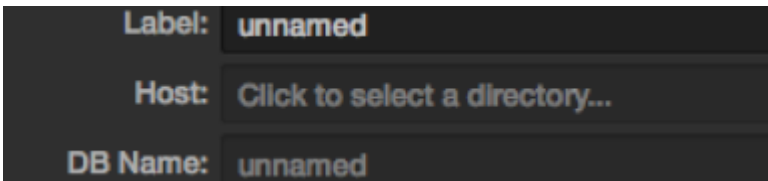

<p>For a new user you will have to set up your account</p> <p>Click on the volumes Icon in the lower right corner of log in screen</p>	
<p>Click the "+" icon in the lower right to add a new user</p>	
<p>Choose "Disk" as the Driver</p>	
<p>Click on "Host" to select a directory to store your settings.</p>	

Make a folder on the destination hard drive to store the user database

Click "Choose"

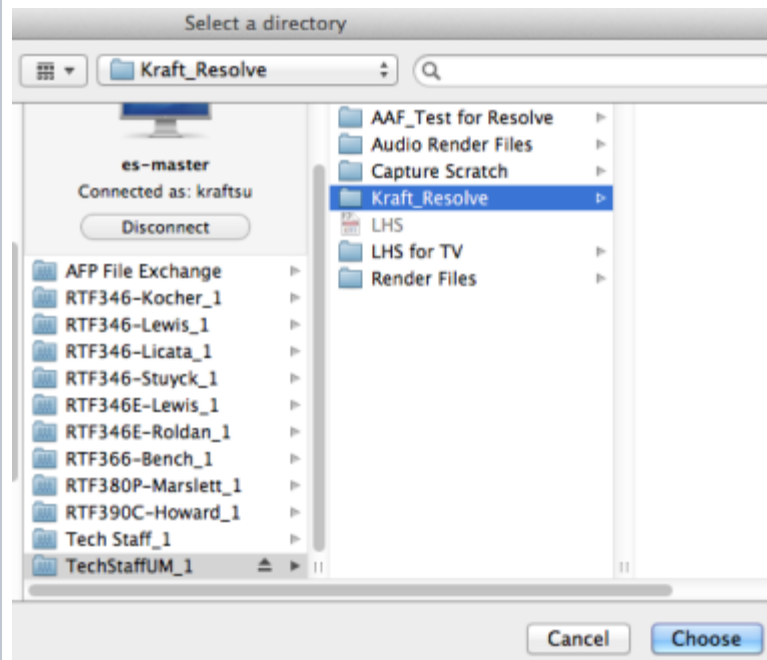

Label your User Database

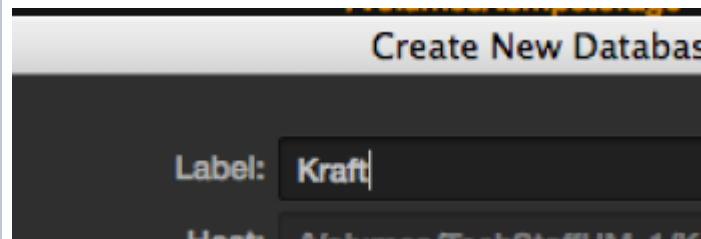

Choose to create new database

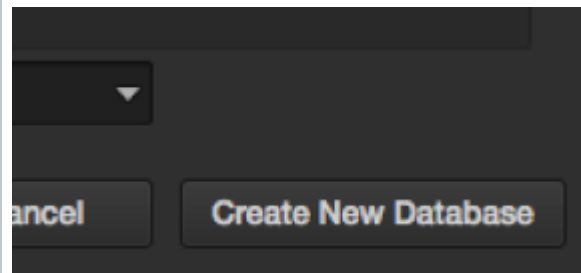

Database creation successful. Next Double Click on the new database you just made. Example here in "Yellow Font" double click on that to load it.

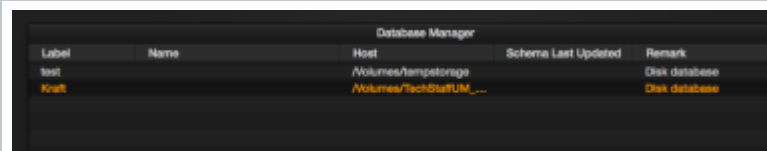

Close the window

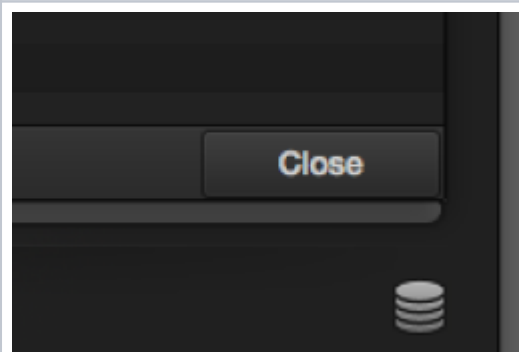

Next create a "New USER"

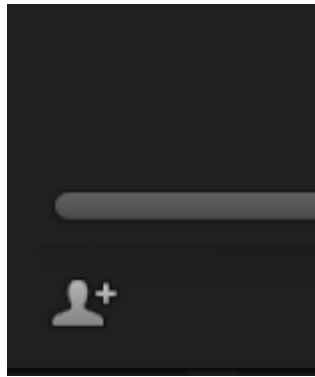

Enter in Username

Click Setup new user

A screenshot of a 'Setup New User' dialog box. At the top, it says 'Setup New User'. Below that is a camera icon with the text 'Add a photo'. Underneath are three input fields: 'Username:' with the value 'Kraft', 'Password:', and 'Verify:'. At the bottom are two buttons: 'Cancel' and 'Setup New User'.

Log in



Click the "+" button in the lower left corner to create a new project

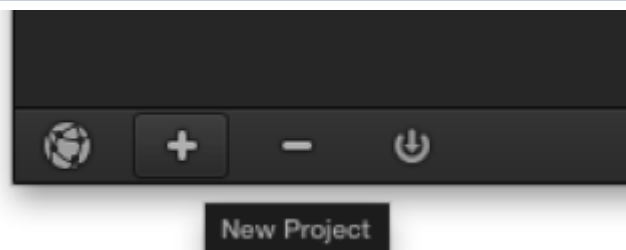

Title the project – click Create

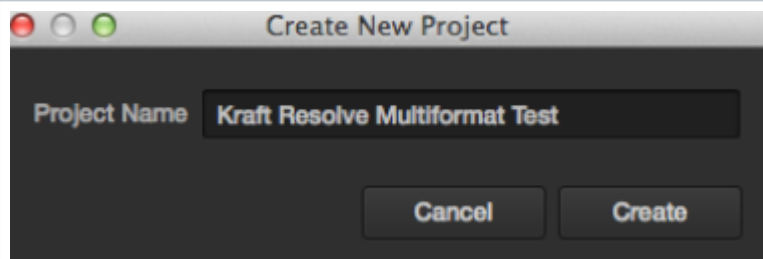

Double click the project to load it

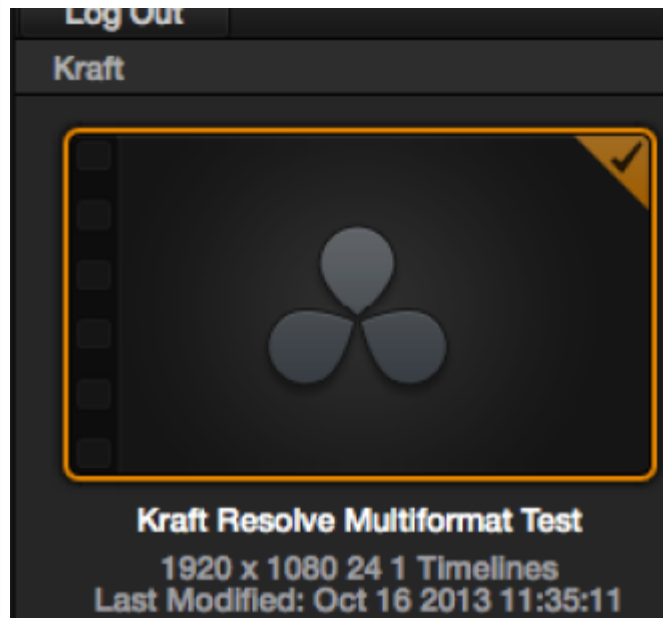

Set up some preferences. Click on the Preferences Icon in the lower left of the screen

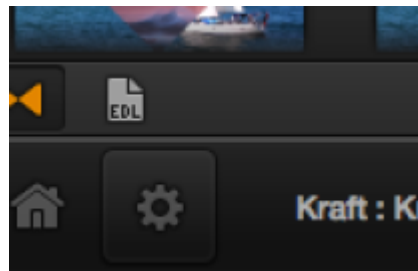

Go to "Autosave" and turn it on saving every 10 min

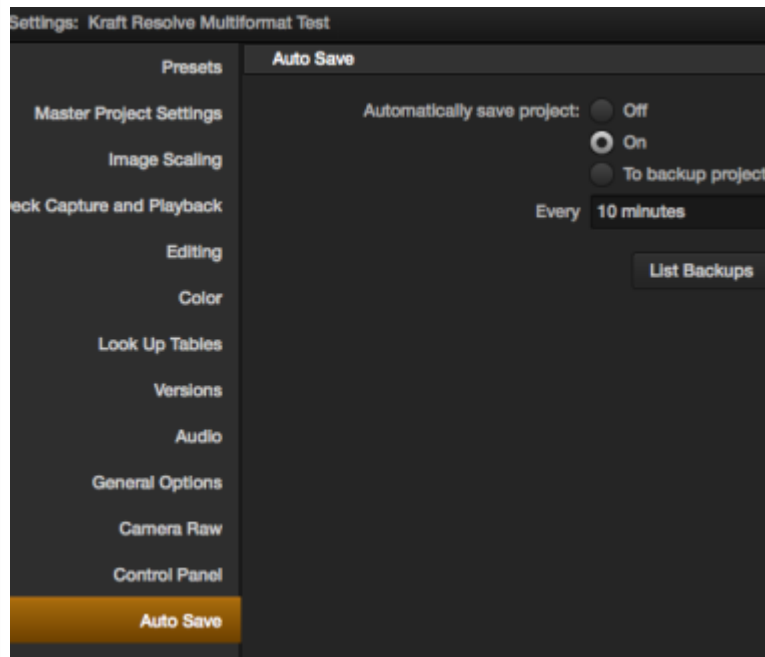

Also can choose some decoding presets – If you are using footage from a Red – Arri – Sony etc choose the correct decoder.

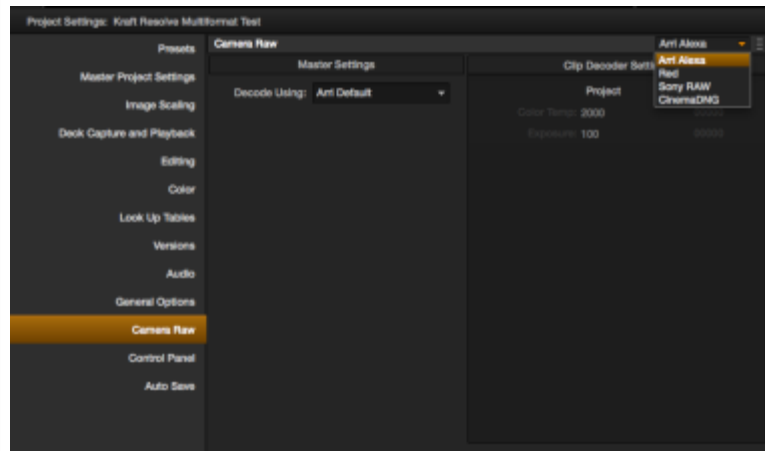

Have not tried this but if you want to do any editing you can pick keyboard settings

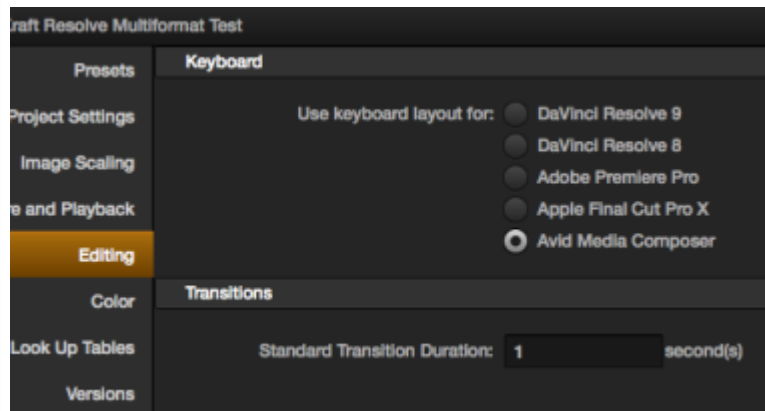

Monitor playback settings chosen here. Choose HD 1080PsF 23.976 generally

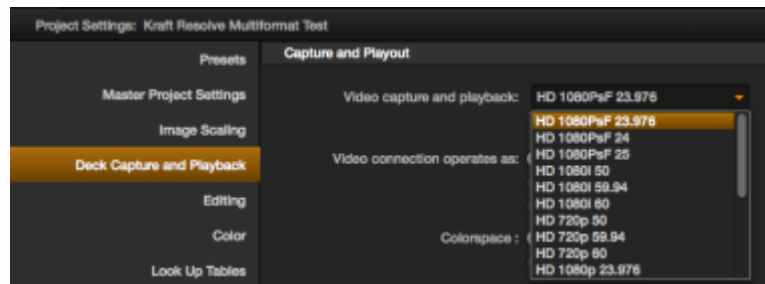

Master Project Settings generally will want 1920 x 1080 but if you have 2K footage and want to scale up then choose 2048 x 1080 or 2048 x 1024

4K Red files are 4480 x 1920 but check the raw .r3d file

Choose either the DaVinci YRGB or the DaVinci ACES color science. For Red Footage you may see more detail in ACES.

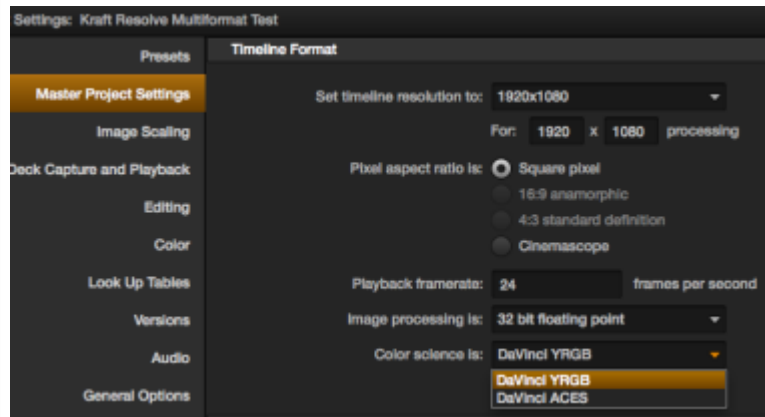

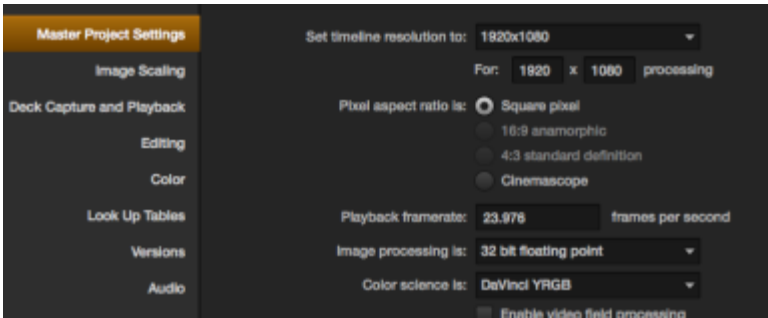
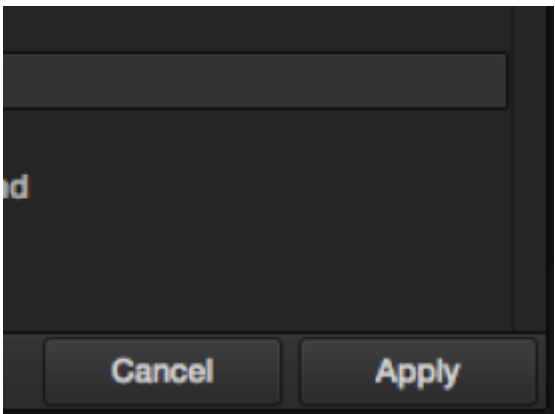
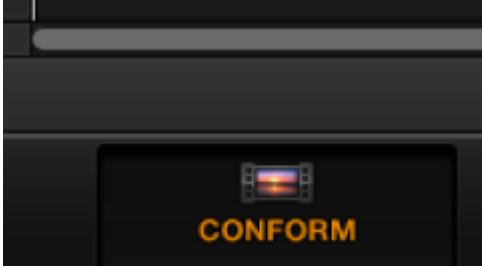
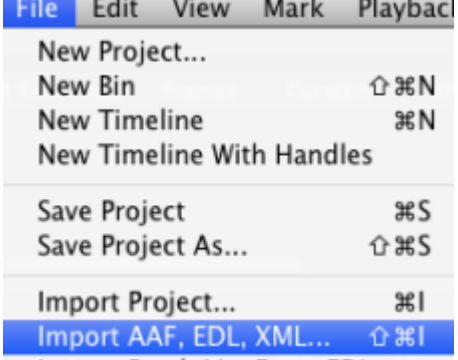
<p>Change the playback framerate to 23.976</p>	
<p>Click "Apply" to apply the settings</p> <p>Close the Preferences window</p>	
<p>Click on the "conform" tab at the bottom of the screen on the "navigation" bar</p>	
<p>&gt;File&gt;Import AAF, EDL, XML</p>	

Select the .aaf to import

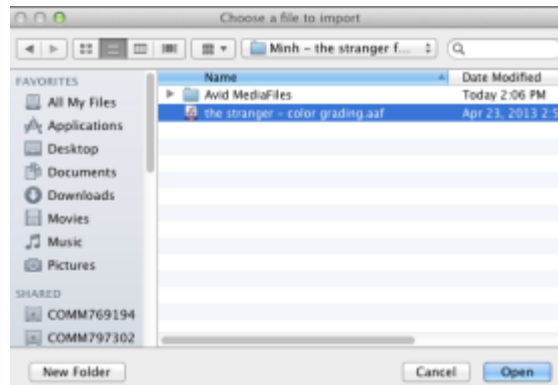

Resolve Lite will limit you to 1920 x 1080 23.98

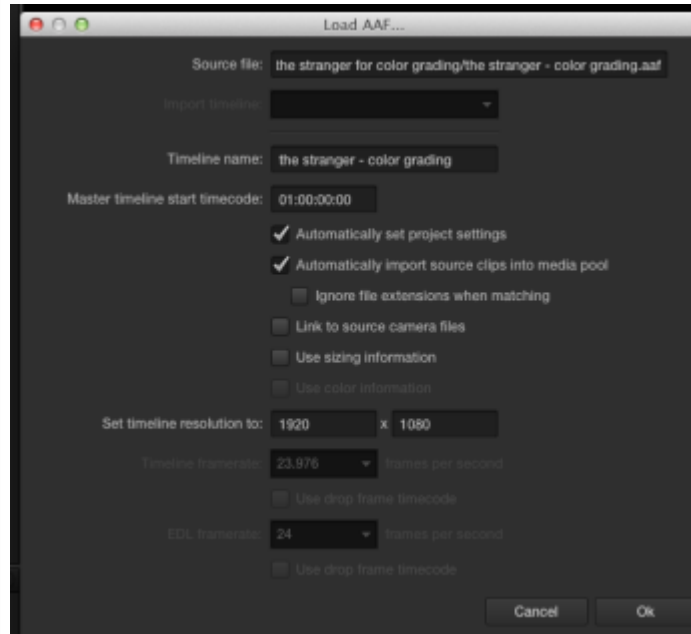

All the clip files related to the .aaf will now import into the Resolve project and populate the timeline.

Sometimes the clips can't be found by Resolve - If you have problems continue with the next few steps.

In any case you will also have to import your QuickTime Reference file of the offline. See this Wiki Doc. [Davinci Resolve – Quicktime Reference Import and Setup](#)

Select Yes

Search for the folder containing the .mxf

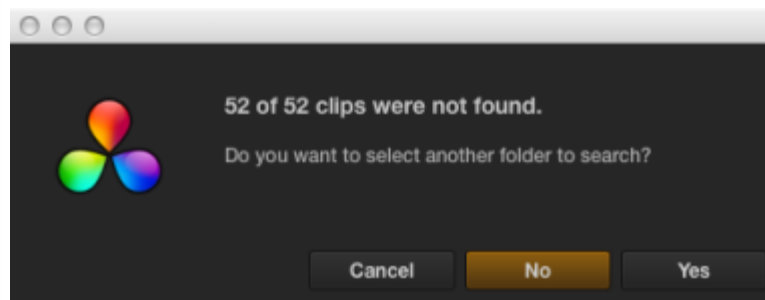

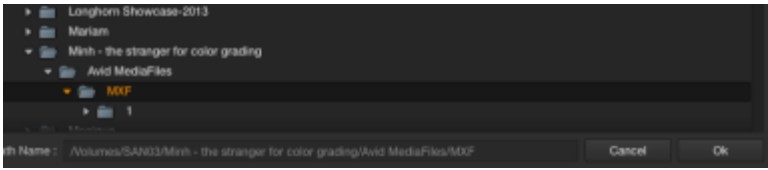
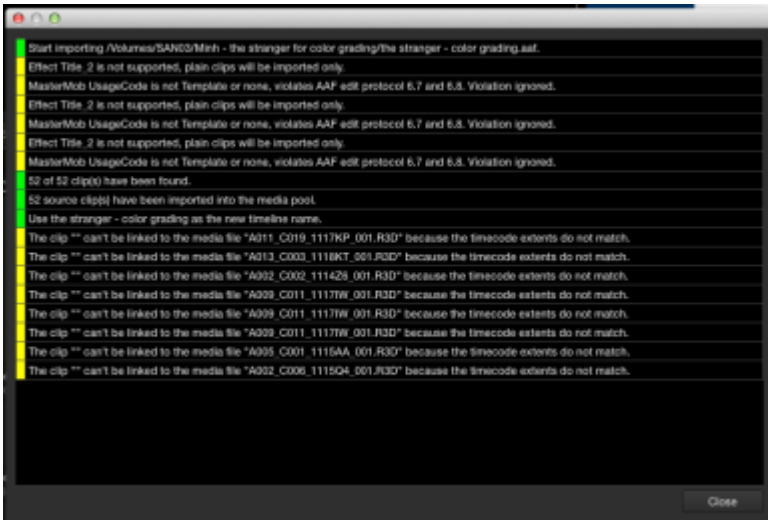
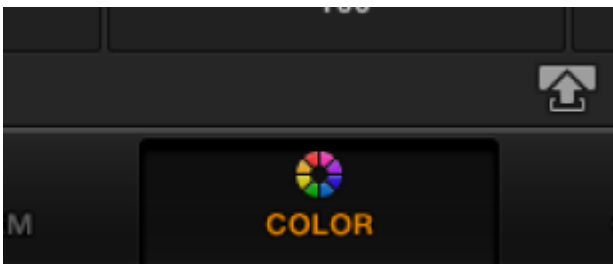
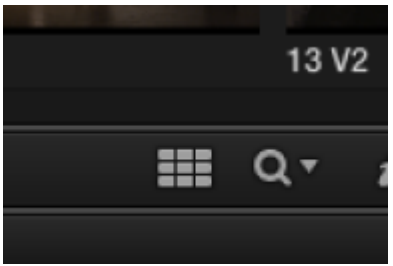
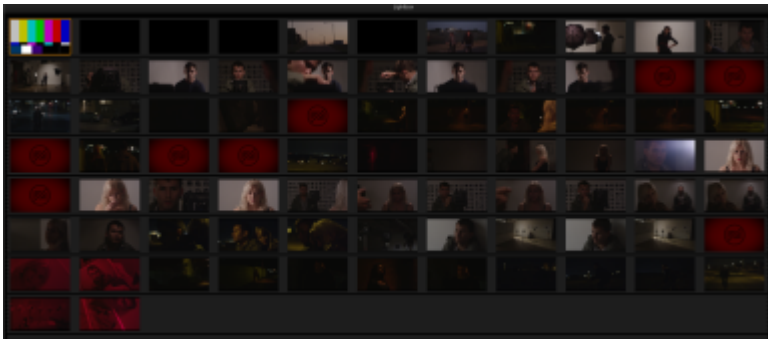
<p>Navigate to the folder and click OK</p>	
<p>Example here of problems with some of the clips</p>	
<p>To view what is missing easier click on the "Color" tab</p>	
<p>Then click on the "Light Box View"</p>	
<p>Here we can see what is missing easier.</p>	

You can right click to see clip info

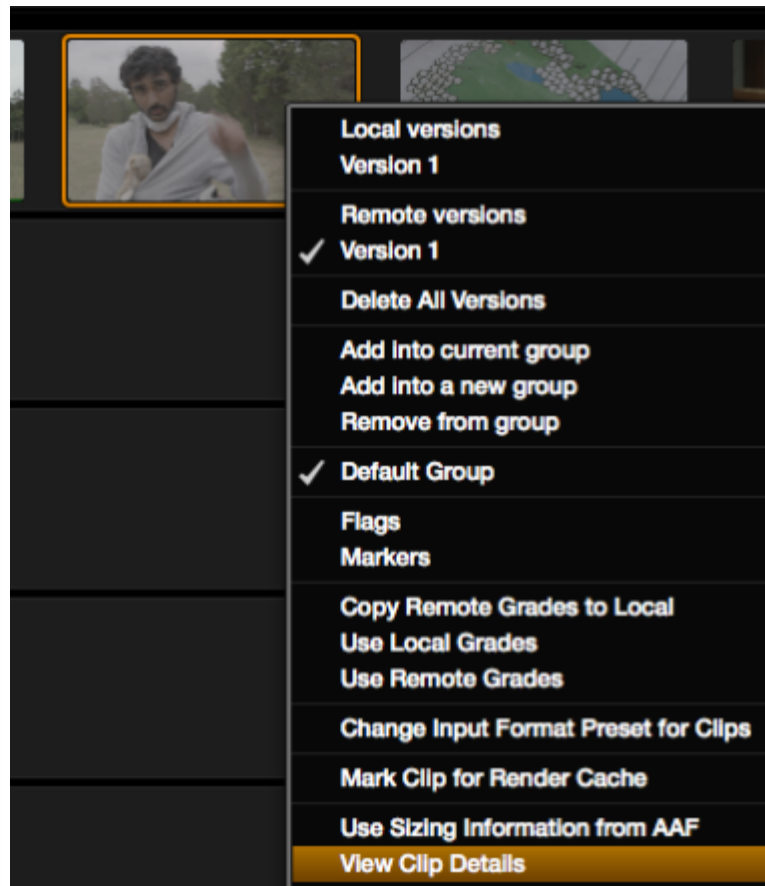

Clip info

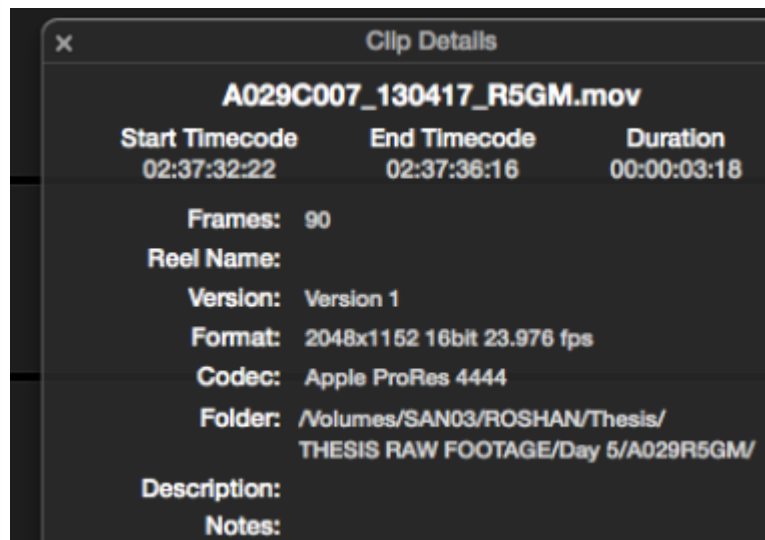

Click on EDL in the lower left of the screen to load in the edited clip info

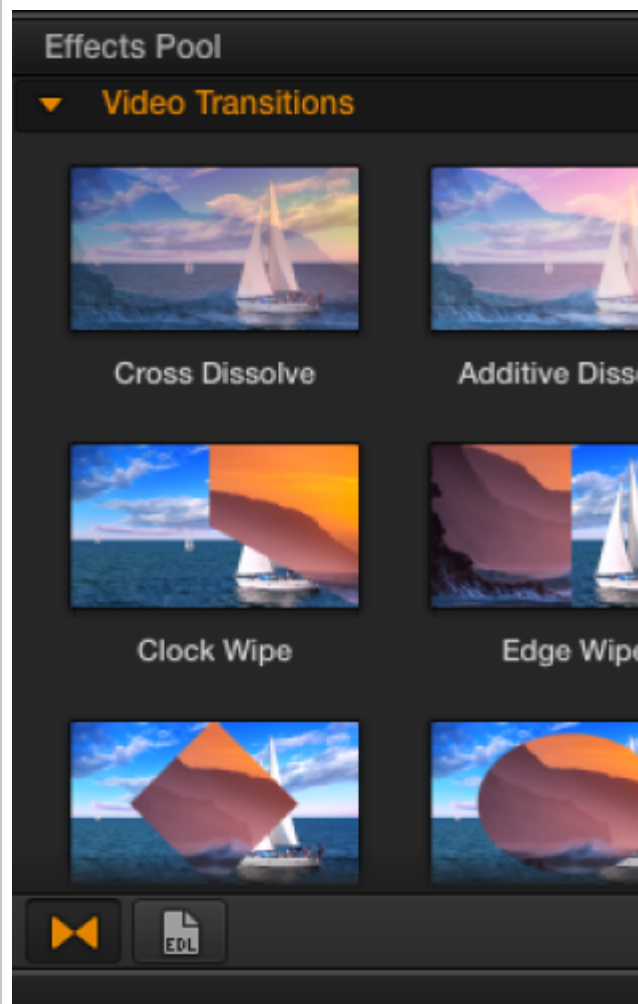
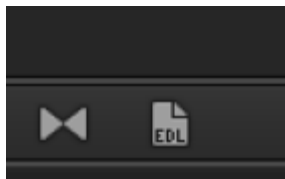

Example of an EDL of the  
Resolve files

Effects Pool					
#	Reel	V	C	Dur	Source In
1	SMPT...	V	C		01:00:00:00
2	BL	V	C		160:24:12:00
3	BL	V	C		160:24:23:00
4	BL	V	C		160:24:23:00
5	A002_...	V	C		23:39:08:03
6	A002_...	V	C		00:45:52:23
7	A001_...	V	C		21:38:30:06
8	A002_...	V	C		00:46:17:12
9	A001_...	V	C		21:38:43:02
10	A002_...	V	C		00:46:34:16
11	A001_...	V	C		21:38:52:12
12	A002_...	V	C		00:46:54:12
13	A002_...	V	C		23:41:03:23
					